



Submersible Dewatering Construction Pump

HS (Manual)

HSZ (Auto)



HIGH Efficiency
Energy Saving
Extended Life Span
Low Running Costs
Portable Dewatering Pump

■ Application Examples

1. General Water Intake or Draining
2. Dewatering in Construction Site
3. Draining Water from Basement / Cellar / Pits
4. Draining of Rain Water and Puddle
5. Draining of Treated Water in Water Treatment Plants
6. Water Intake for Gardening or Irrigation

Portable, Easiness in Handling, Longevity, Maintainability and Low Running Costs.

■ Features

Energy Saving (Automatic Type)

The pump operates only when necessary according to the amount of water that builds up on site, which results in greater energy savings compared with conventional non-automatic models.

Oil Lifter (Patent Pending)

The pump has a built-in Oil Lifter designed to stabilize the mechanical seal function by efficiently supplying the lubricant to the seal even if it drops to below the rated level. This amazing simple device turns otherwise wasted energy into an additional protection effect for the seal and extends both seal life and maintenance intervals.

Agitator for Clog Prevention

An agitator, installed under the impeller, disperses debris and suspends solid particles, preventing impeller lock and reducing the possibility of clogging.

Anti-Wicking Cable Entry

Cable entry is an important part in submersible pumps. Tsurumi's care has been extended to the sealing of the strand of the cable conductors that may accidentally cause the ingress of water by a wicking (capillary phenomenon).

Built-In Motor Protection

A miniature motor protector is installed in the motor. It automatically stops the pump from operating in case of an excessive heat built up in the motor caused by overloading.

Dual-Face Mechanical Seal

The pump is provided with a silicon carbide (SiC) dual-face mechanical seal housed in an oil filled chamber. The motor is double protected from ingress of water.

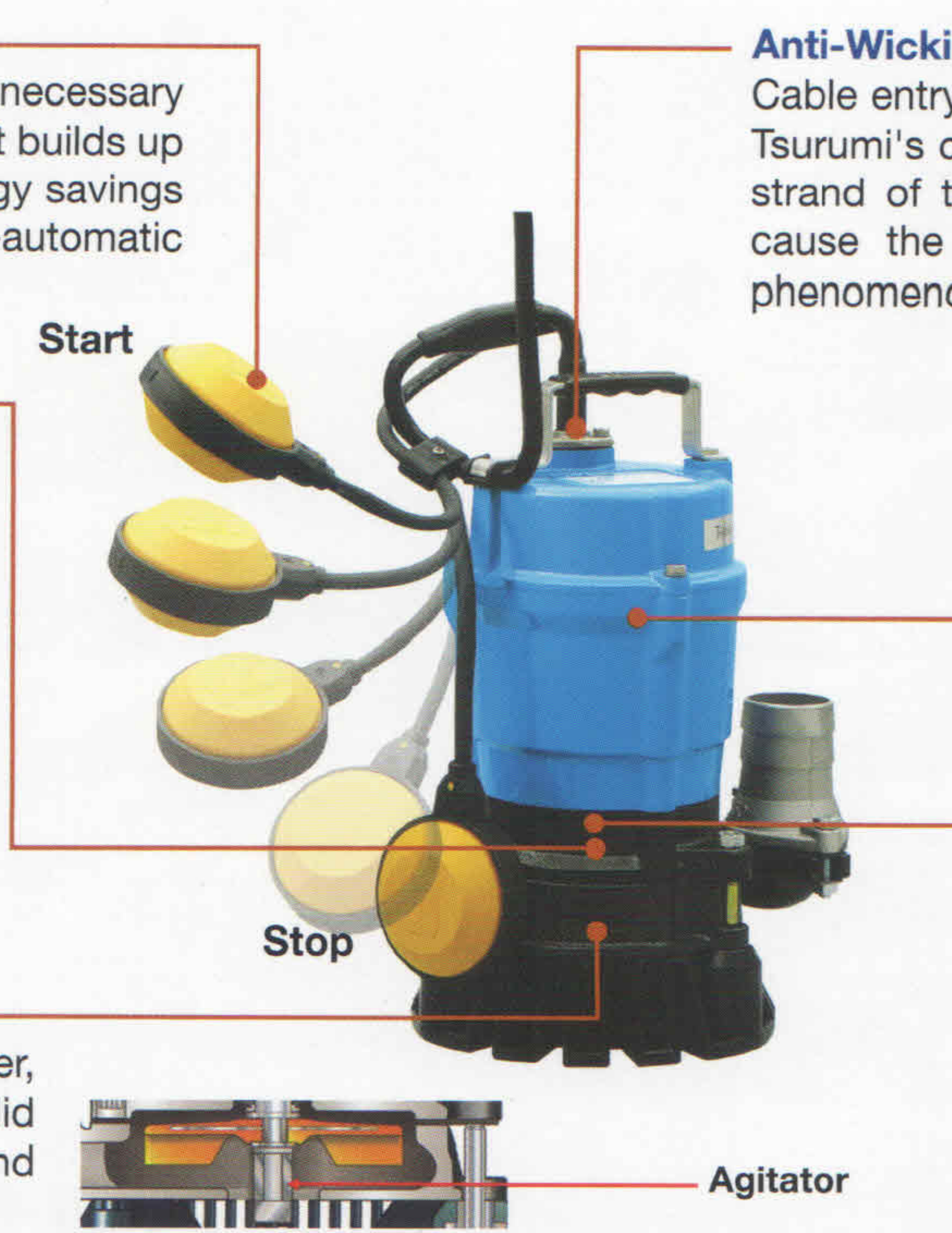

■ Performance Curves

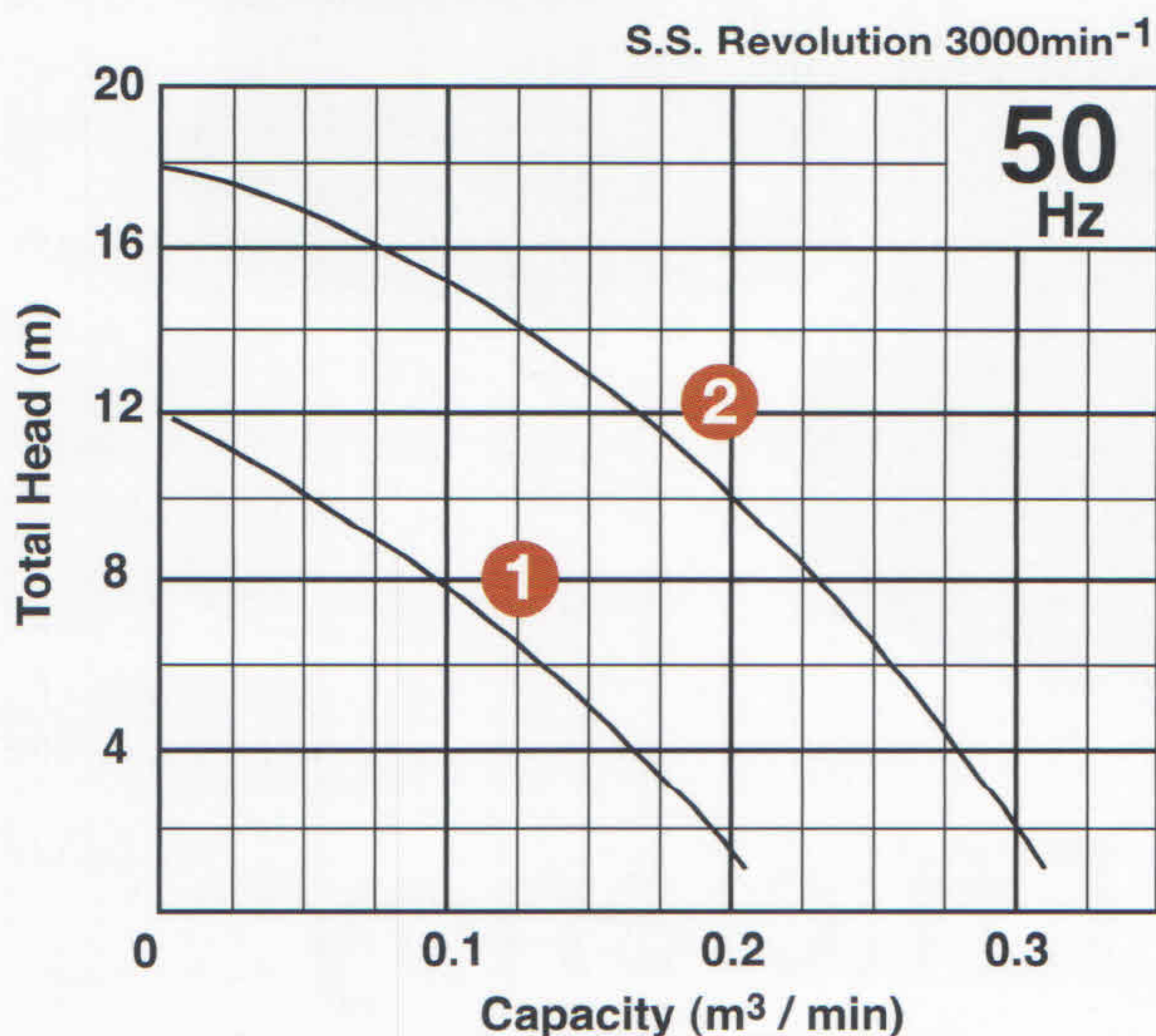

■ Dimensions

Manual

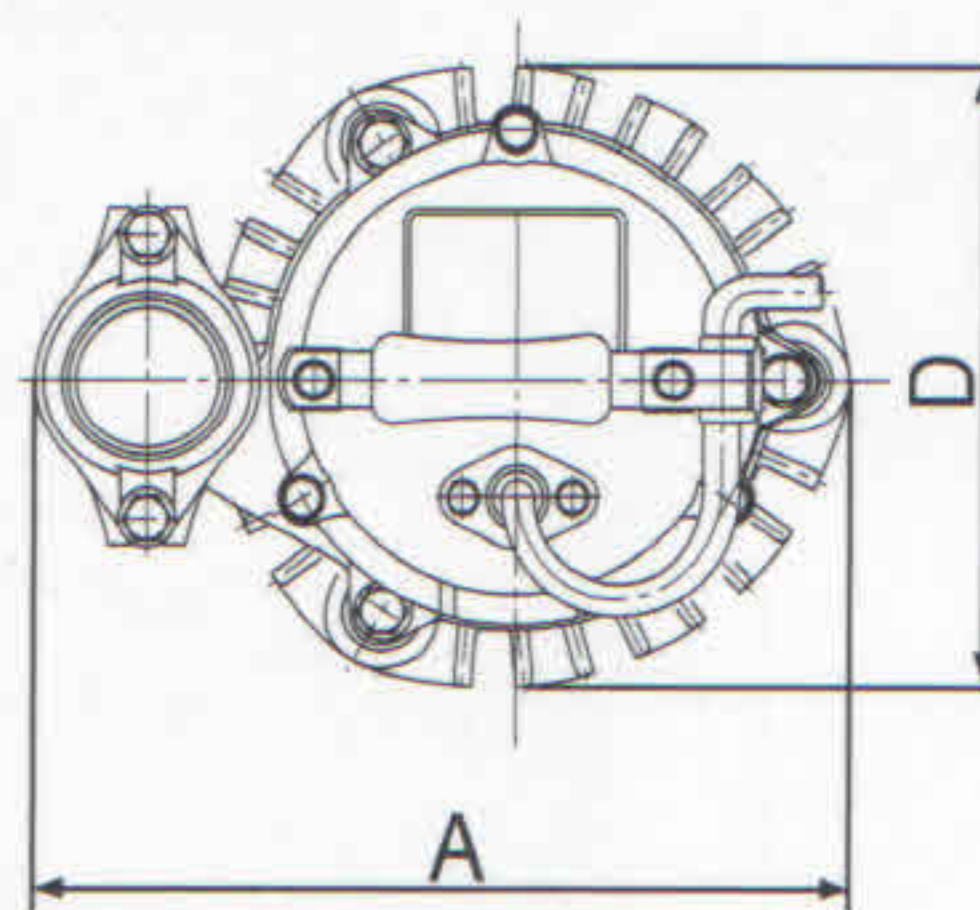

Auto

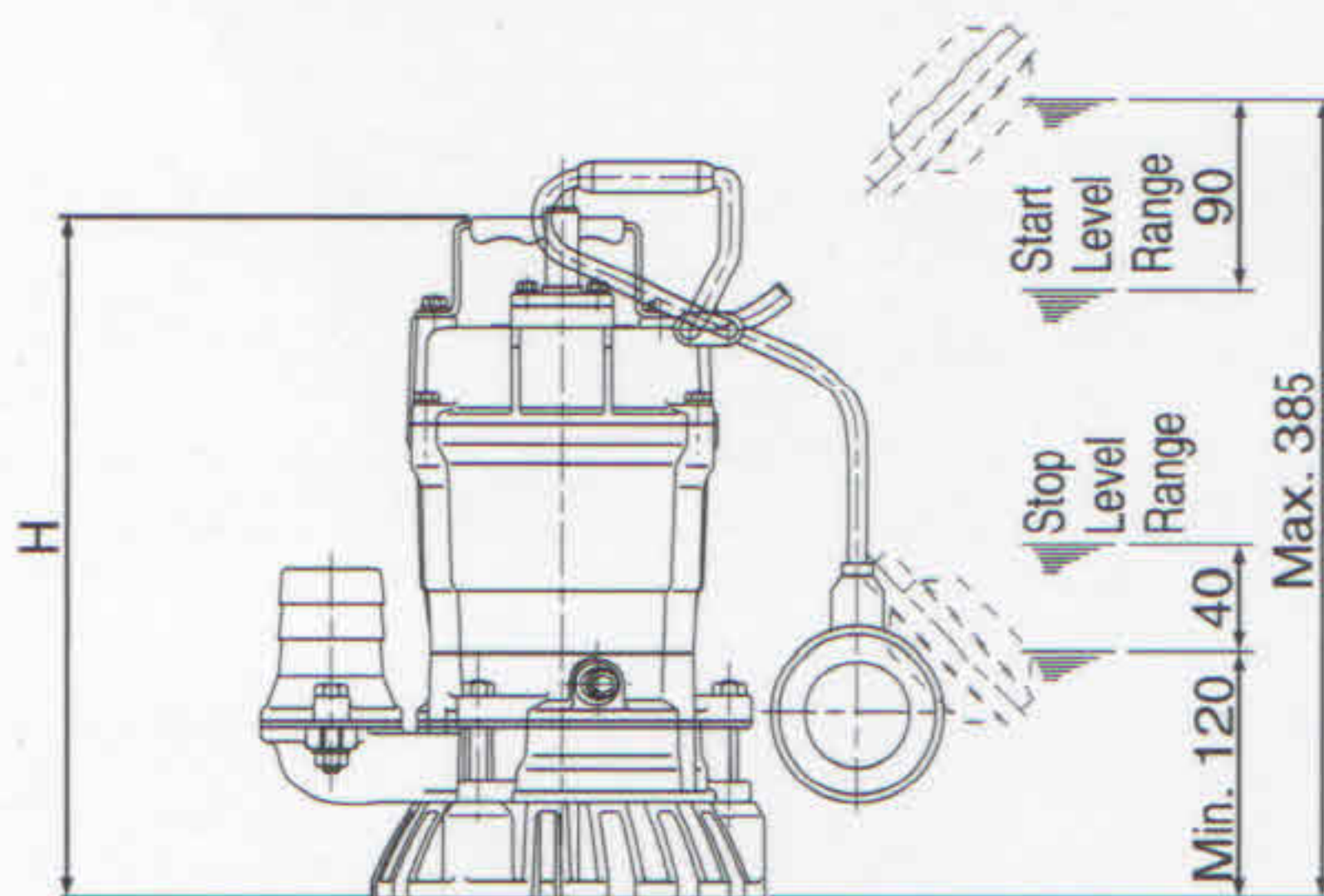
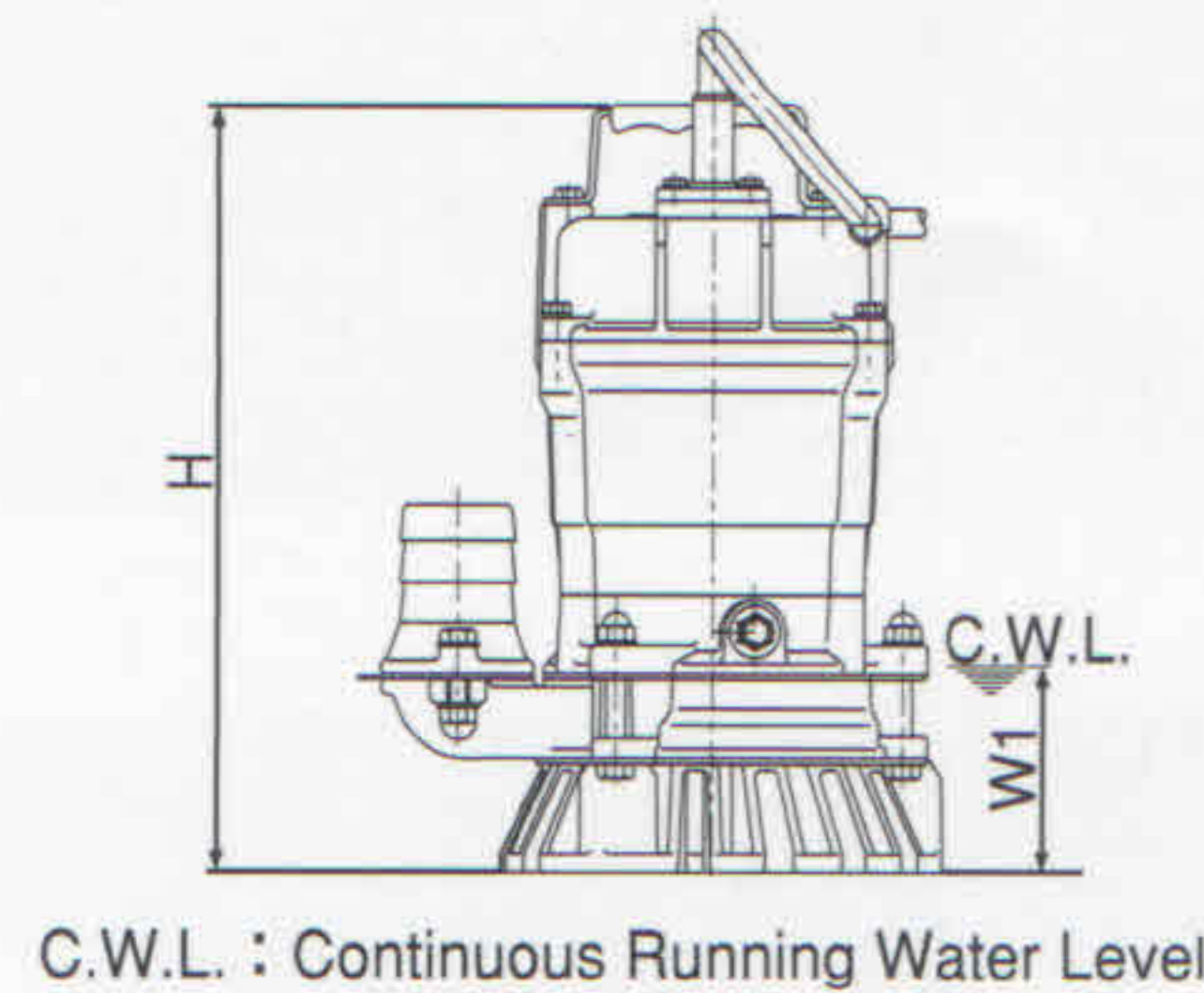
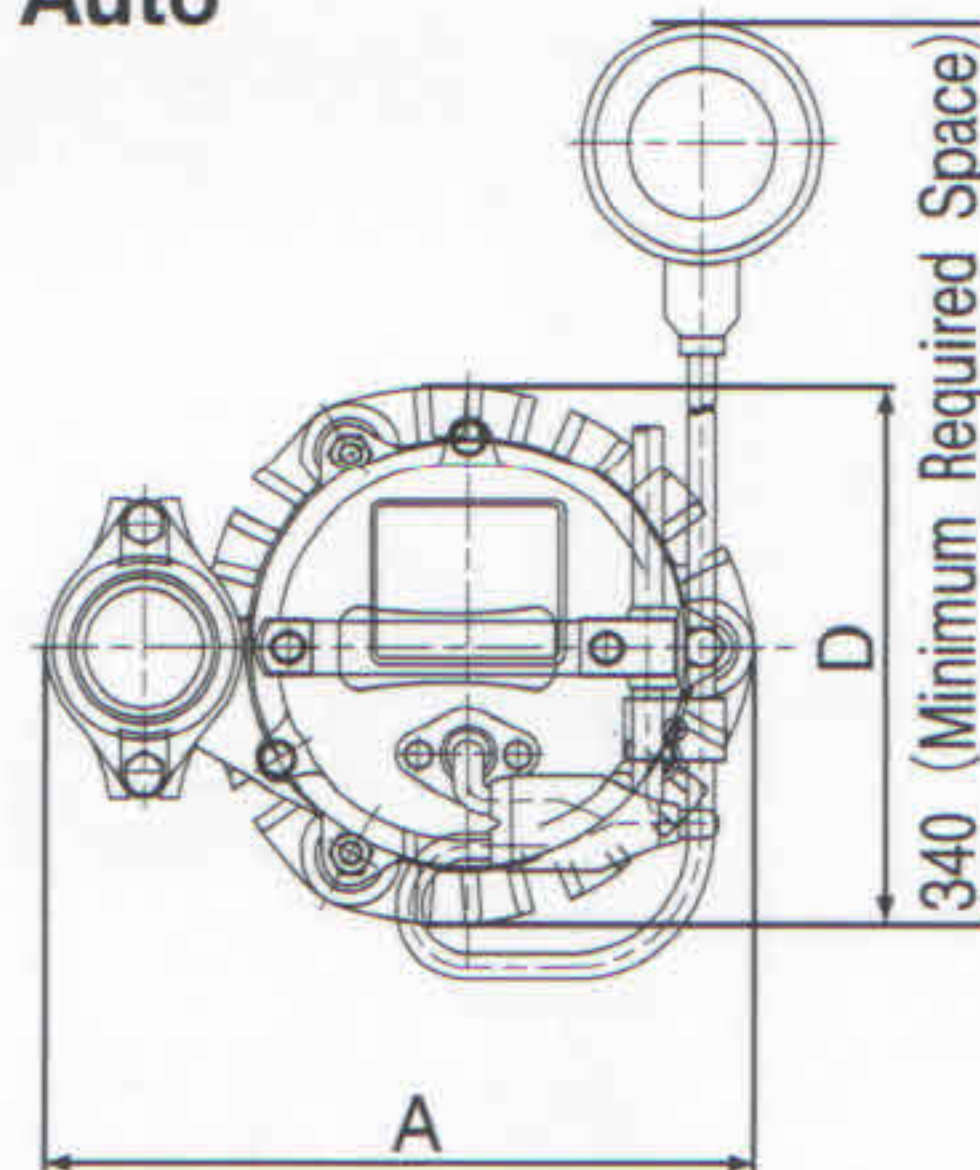

■ Specifications

Curve No.	Discharge Bore (mm)	Model		Motor Output (kW)	Phase	Max Head (m)	Max Flow Rate (m ³ /min)	Auto		Std. Cable Length (m)	Dry Weight (Kgs)	Dimensions (mm)			C.W.L (mm) W1
		Manual	Auto					Start Level (mm)	Stop Level (mm)			A	D	H	
1	50	HS2.4S	HSZ2.4S	0.4	Single	12	0.2	385 ⁺⁰ ₋₉₀	120 ⁺⁴⁰ ₋₀	5	11.3	241	185	328	90
2	80 (50)	HS3.75S	HSZ3.75S	0.75	Single	18	0.3	445 ⁺⁰ ₋₉₀	180 ⁺⁴⁰ ₋₀	5	17.5	285	185	388	90

- Dry weight of the pump excluding cable.
- For motor output of 0.75kW, 50mm discharge is available upon request.

■ Standard Accessories

- Cabtyre Cable 1pc
- Hose Coupling 1pc
- Hose Band 1pc

■ Optional Specifications

- Extended Cable